



Chatsworth Terrace

Darlington DL1 5DH

Guide Price £65,000





This footer paragraph is an example only and should not be relied upon as complying with current legislation. These particulars, whilst believed to be accurate are set out as a general outline only for guidance and do not constitute any part of an offer or contract. Intending purchasers should not rely on them as statements of representation of fact, but must satisfy themselves by inspection or otherwise as to their accuracy. No person in this firms employment has the authority to make or give any representation or warranty in respect of the property.

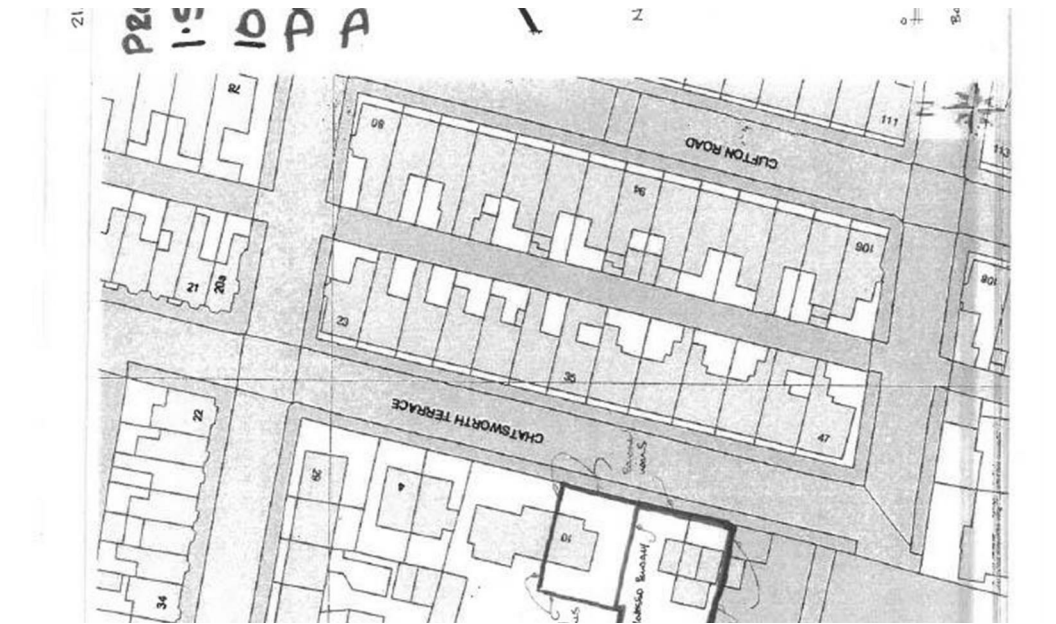
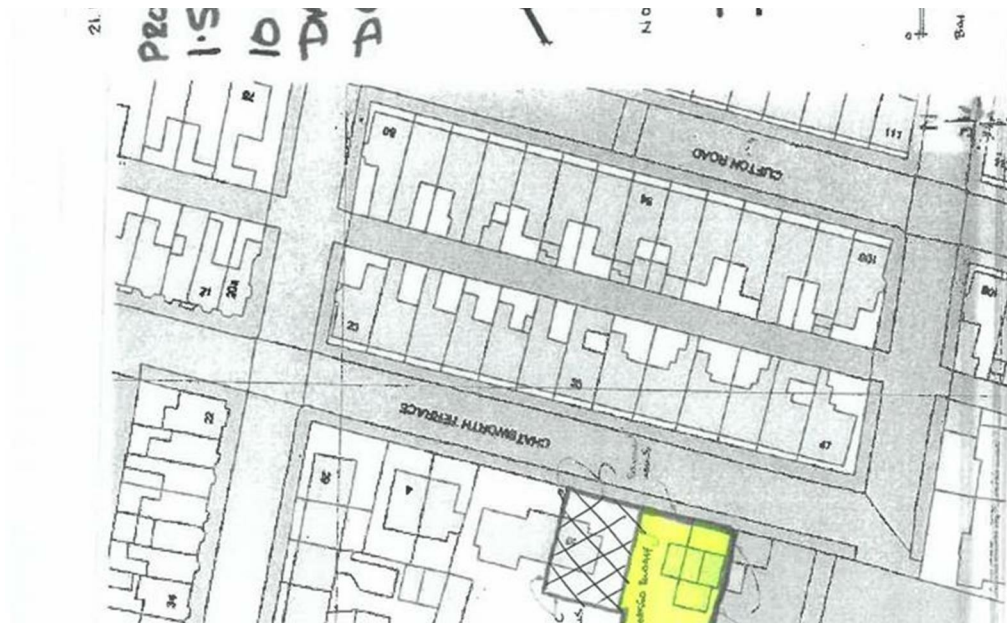

Chatsworth Terrace

Darlington DL1 5DH



x

null



x

null



x

null

DEVELOPMENT OPPORTUNITY FOR A PLOT OF LAND TO THE SIDE OF 10 CHATSWORTH TERRACE, (CURRENTLY A BLOCK OF THREE SINGLE GARAGES). OUTLINING PLANNING IN PLACE FOR UP TO THREE PROPERTIES.

Link for planning application

<https://publicaccess.darlington.gov.uk/online-applications/applicationDetails.do?keyVal=QVRND8FP0F600&activeTab=summary>

Planning Application Link

<https://publicaccess.darlington.gov.uk/online-applications/applicationDetails.do?keyVal=QVRND8FP0F600&activeTab=summary>

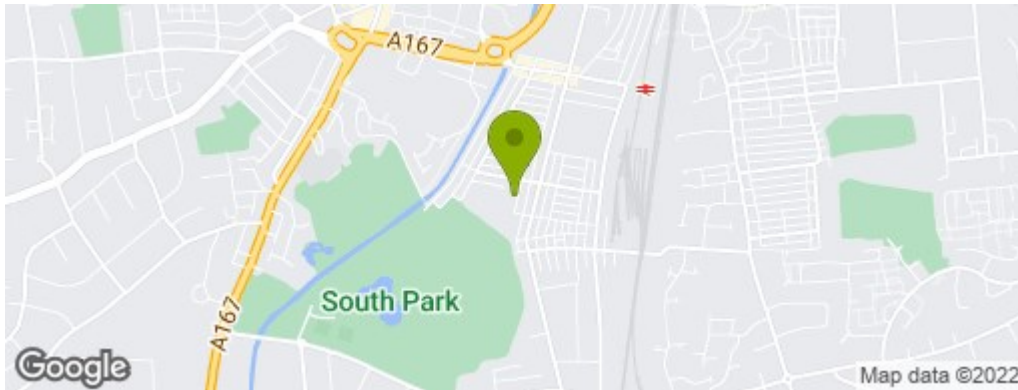

Property Information

01325 363858

45 Duke Street, Darlington, County Durham, DL3 7SD
sales@venturepropertiesuk.com